



## PS200 - LMP

Portable Gas Monitor



### Description

The PS200-LMP has been developed collaboratively with Con-Edison, National Grid and the New York City Licensed Master Plumbers (LMPs), to provide a fit-for-purpose gas detection and monitoring instrument that meets the evolving needs of plumbing technicians.

This multi-use detector is specifically designed to address the gas monitoring practices of the plumbing and HVAC communities and will enhance gas safety.

With three modes of operation, this gas detector can be used by LMPs and their technicians to conduct regulatory compliant leak surveys of gas piping inside buildings. Results from leak surveys can be transferred, via Bluetooth, to applications running on tablets allowing the survey data to be visualized and then stored in the cloud for regulatory reporting purposes by a Utility.

The PS200-LMP also assists with daily duties including purging of interior piping and provides atmosphere monitoring for both flammable gas and carbon monoxide (CO).

### Features

- Easy to use
- 3 modes of operation: Inspection (Leak survey), Personal Surveyor and Purge
- BIN number entering
- % Volume Gas and ppm Carbon Monoxide gas detection
- Audible and visual alarms
- Datalogging
- Bluetooth communications enabling mobile app pairing
- Internal pump
- Rechargeable battery
- Easy maintenance
- Supplied with probe and filters
- Certified for use in hazardous environments
- Switches off if calibration is overdue



# PS200 - LMP

Portable Gas Monitor

## Technical Specification

Size:	4.8" x 2.3" x 1.3"		
Weight:	8oz including pump		
Temperature:	-4°F to 122 °F		
Humidity:	0 to 95% R.H non-condensing		
Alarms:	Highly visible flashing LED, piercing >90dB audible		
Set Points	% Vol. Gas	0.1%	
	CO	35ppm	
Display:	Green and red LCD backlight display		
Datalogging:	>180 Inspection results containing PS200 Serial Number ON Time / Date BIN Cal Due Date Pump status Max Reading : % Gas Auto Log Readings : % Gas Manual log Readings: % Gas OFF Time / Date >8 calibration logs >180 logs		
Bluetooth	BLE 5.0 Range - 3 ft		
Battery:	Lithium Ion rechargeable battery Run Time: Up to 24 hrs (diffusion) / 13 hrs (pumped) Charging Time < 4 hrs		
Enclosure:	High impact rubberized polycarbonate case		
Drop Test:	10 ft		
IP Rating:	IP67		
Response Times	Vol. Gas	T50 : <10 secs (CSA 22.2 No. 152) T60 : <12 secs (ANSI 12.13.01) T90 : <20 secs	
Approvals:	CSA Combustible Instruments: Class I, Div. 1, Group C and D T4 Class I, Zone 0, AEx ia IIB T4 Ga		
Warranty:	2 years standard warranty against faulty goods or workmanship. Consumable parts are not included.		

## Sensor specification

Gas	Ranges	Increments	Sensor Type
Vol. Gas	0-100% Vol. Gas	1%	Catalytic Bead
CO	0-1000ppm	1 ppm	Electrochemical

## Features



The instrument has **3 modes of operation:**

### 1. Inspection (INSPT):



User can enter a BIN

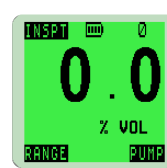

Will record %Gas readings during an inspection



Data can be transferred by Bluetooth to an application

### 2. Personal Surveyor (PS):

Alerts the user to the presence of flammable gas and/or carbon monoxide while carrying out normal plumbing duties.



User can change range or toggle pump



Audible and visual alarms to alert user

### 3. Purge:

Intended for natural gas-to-air or air-to natural gas purging.



User can zero the %VOL reading or toggle the pump



User can also view the MAXimum gas reading



## Automatic Bump Testing and Calibration

To complement the PS200-LMP, we have developed a compact, robust and easy to use Auto Bump & Calibration Station that can provide full bump and calibration options. Data transfer is facilitated using a USB memory stick with Standalone software that is simple to set up and customise based on end users' specifications. Standalone, PC, and ethernet versions are available:

### Standalone

By adding the Auto Bump & Calibration Station, test data can be easily retrieved in a user-friendly time logged format. This gives you the ability to create and print your personalised calibration certificate.

### PC

Allows easy configuration (bump test or calibration) of Auto Bump & Calibration Station and allows all results to be automatically stored to a database on the PC. The stored results can be easily viewed and calibration certificates produced. The history of all results can be easily viewed and reports of instruments can be easily compiled.

### Ethernet

Same as PC except multiple units can be connected to a network allowing one PC to control and receive data.

## Auto Bump & Calibration Station technical specification

Size:	7.9" x 5.5" x 5.3"
Weight:	43oz
Interfaces:	Standalone / USB / Ethernet
LED Indicators:	Power (Green) / Testing (Yellow) / Pass (Green) / Fail (Red)
Testing Time:	Bump Test 60 secs Calibration Test 2 mn
Data Storage:	up to 5000 Bump & Calibration results
Power Supply:	12V dc, 2A
Operating Temperature:	14°F to 104°F
Gas Ports:	4 (Air, Combi Gas, 100% Methane & Exhaust)

# PS200 - LMP

Portable Gas Monitor

## Instrument Maintenance

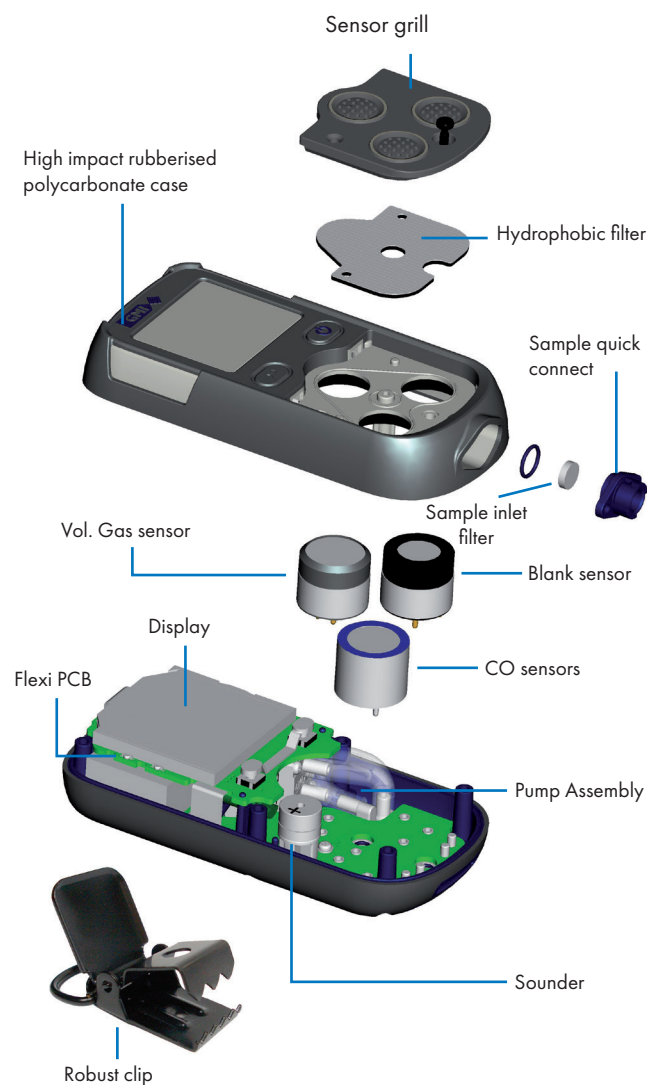

## Probe Maintenance

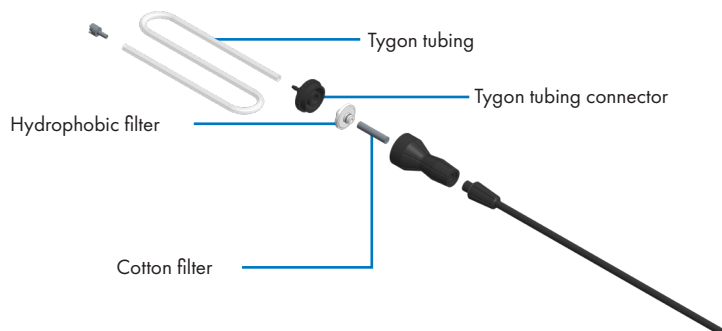

## PS200 - LMP Instrument

64135LMP PS200LMP c\w %Gas, PPM CO, Probe, Bluetooth, rubber boot

## Spare parts - Instrument

64254	Hydrophobic Filter (Instrument)
64084	Sample Inlet Filter (Instrument)
67176	CO sensor
66750CC	% Vol. Gas Sensor
64255	Pump Assembly

## Spare parts - Probe

64109	Probe c\w filters and tubing
12358	Hydrophobic filter (probe)
10077	Cotton filters - box of 10 (probe)
66118	Tygon tubing
66045	Tygon tubing connector

## Spare parts - Instrument accessories

64260	USB Charging / Comms Clip
64247	Universal Power Plug (Mains - USB)
64172LMP	Quick Operating Instructions
64303BU	Rubber boot (blue)

## Charging accessories

64248	In-Vehicle Charging Adaptor (12V/24V - USB)
64491	In-Vehicle Charging Cradle
64138	5 Way Multi-Charger



## Automatic Bump & Calibration (ABC)

64053	Auto Bump & Calibration Station (Air, 2 Gas, Exhaust)
99553	flexiCal Plus software for PC
99118	Demand Flow Regulator

As an ISO 9001 approved company, Teledyne Gas Measurement Instruments quality assurance programmes demand the continuous assessment and improvement of all Teledyne GMI products. Information in this leaflet could thus change without notification and does not constitute a product specification. Please contact Teledyne GMI or their representative if you require more details.